

REV.	ECN NO. / DESCRIPTION	DATE
1	SN70033	3/1 '07

NOTES:

1.MATERIALS:

HOUSING:LCP UL94V-0 COLOR:BLACK

COVER:LCP UL94V-0 COLOR:BLACK

TERMINAL:C5210 T=0.20

2.FINISH:SEE TABLE 1.

3.TOLERANCES NON-CUMULATIVE.

4.ACCORDING TO THE ENVIRONMENTAL REQUIREMENT,WE GUARATEE THE CONTROLLED HAZARDOUS SUBSTANCES MEET ROHS REQUIREMENT

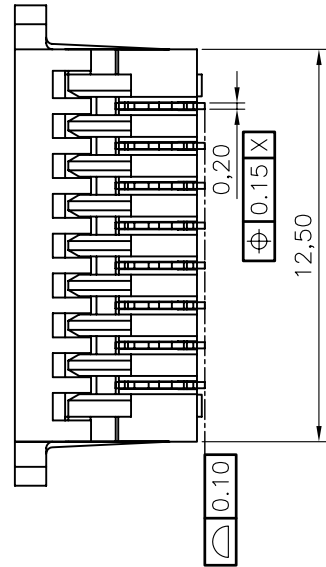
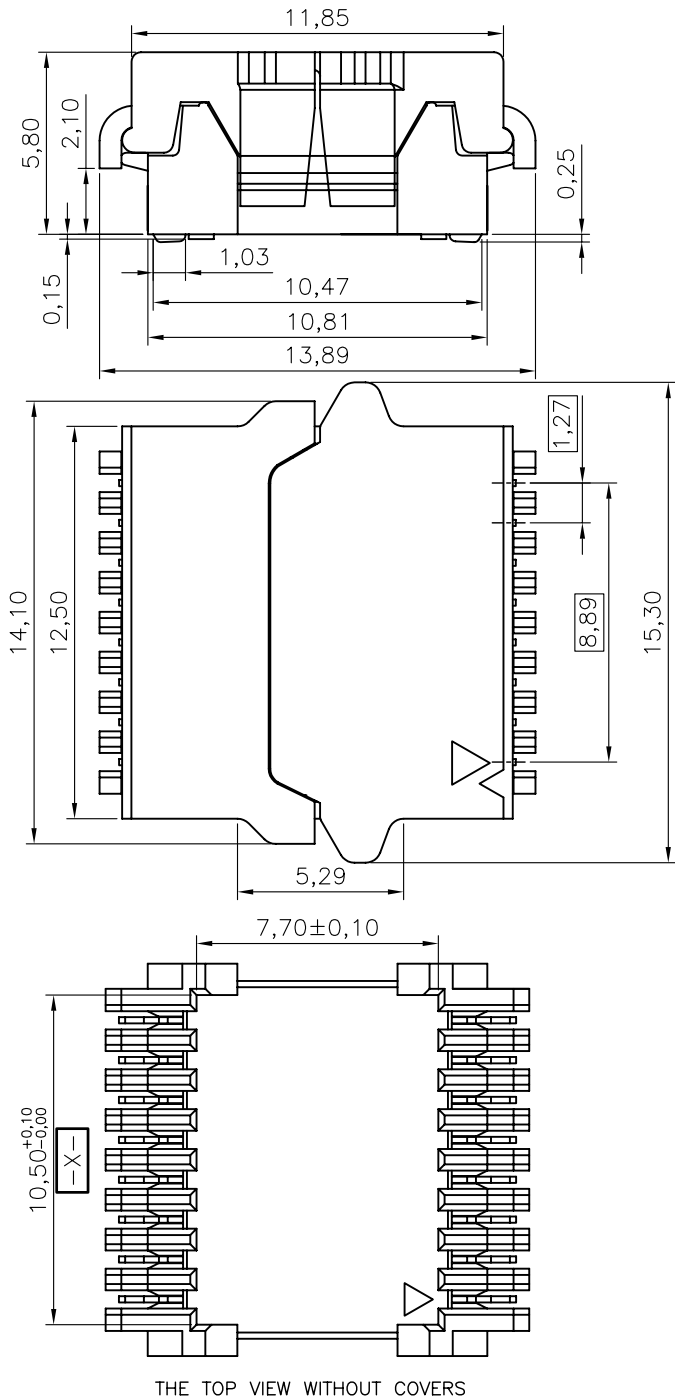

Table 1.

ACA-SPI-006-K01

LCP-BLACK; Cu Alloy w/ Au Flash Plating over Ni

ACA-SPI-006-K03

LCP-BLACK; Cu Alloy w/ Sn 80-120μ" over Ni

GENERAL TOLERANCES UNLESS SPECIFIED		PART NO. ACA-SPI-006-K01	CHUPOND AMERICA			
.X ±0.35	X.° ±3°		APPROVED BY SEAN 3/ 1'07	TITLE SPI FLASH SOCKET FOR SOIC 16PIN		
.XX ±0.25	.X.° ±2°	CHECKED BY KAKA 3/ 1'07	DWG NO. AP-ACA-SPI-006-K			
.XXX ±0.15	.XX.° ±1°	DRAWN BY ANNY 3/ 1'07		SHEET 1 / 2	SCALE 4 : 1	REV 1
SIZE A4	UNITS MM[INCH]					

REV.	ECN NO. / DESCRIPTION	DATE
1	SN70033	3/1'07

RECOMMENDED MATING  
ASSY'S OUTLINE

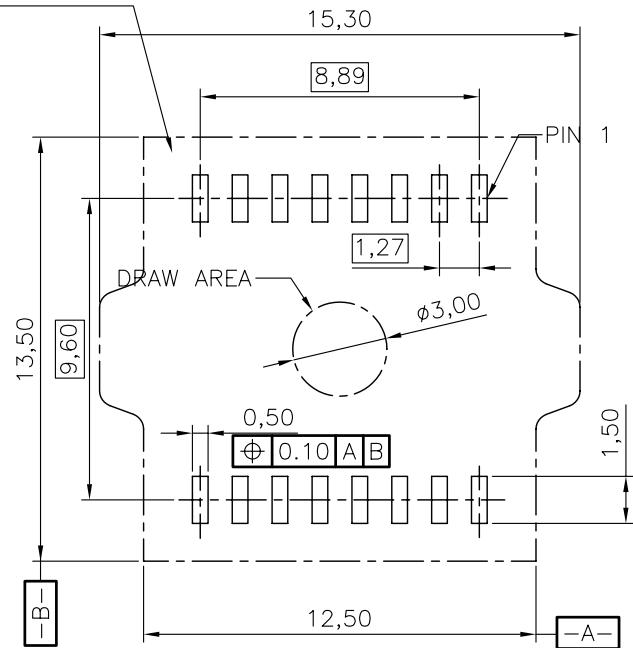

RECOMMENDED PCB LAYOUT FOR USE  
CONNECTOR MOUNTING SIDE

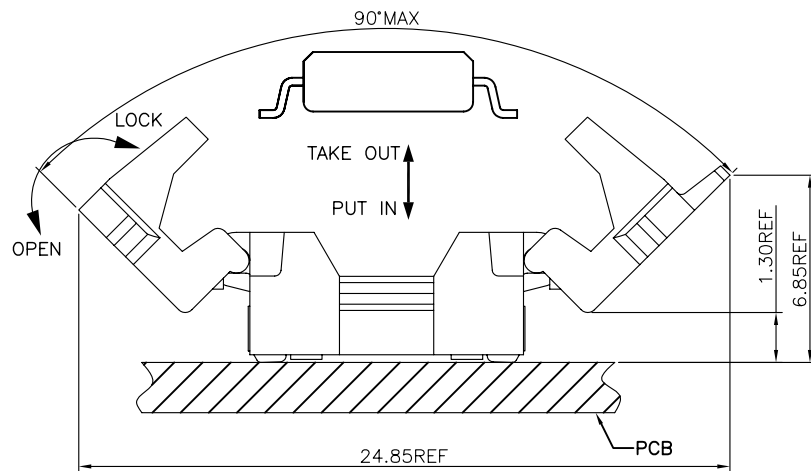
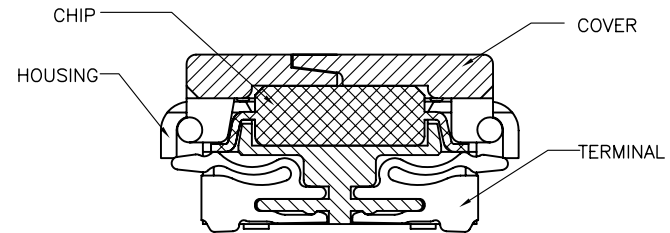
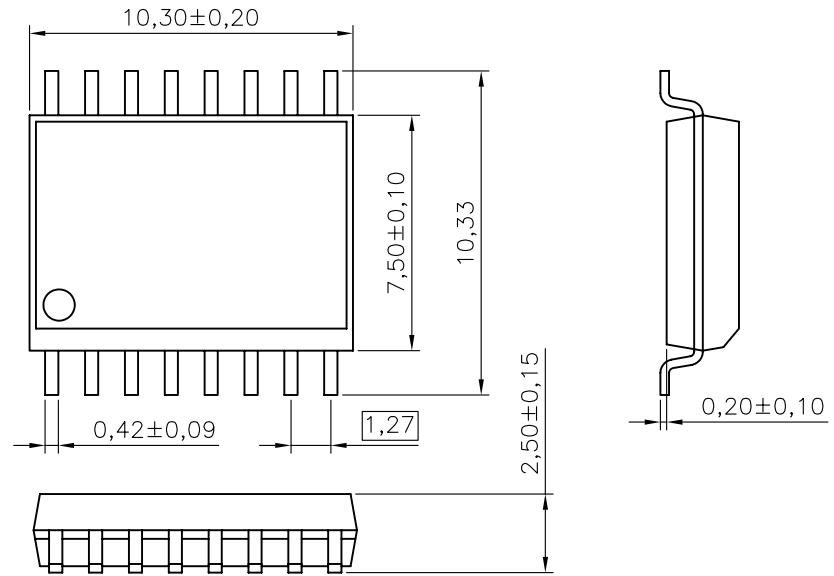

GENERAL TOLERANCES UNLESS SPECIFIED		PART NO. ACA-SPI-006-K01	CHUPOND AMERICA			
.X ±0.35	X.° ±3°					
.XX ±0.25	.X.° ±2°	APPROVED BY SEAN 3/1'07	TITLE SPI FLASH SOCKET FOR SOIC 16PIN			
.XXX ±0.15	.XX.° ±1°	CHECKED BY KAKA 3/1'07	DWG NO. AP-ACA-SPI-006-K			
CUSTOMER DRAWING		DRAWN BY ANNY 3/1'07		SHEET 2 / 2	SCALE 4 : 1	REV 1
SIZE A4	UNITS MM [INCH]					